

Beaconsfield Road

KNOWLE

APPROXIMATE FLOOR AREA
229.9 SQM / 2475 SQFT

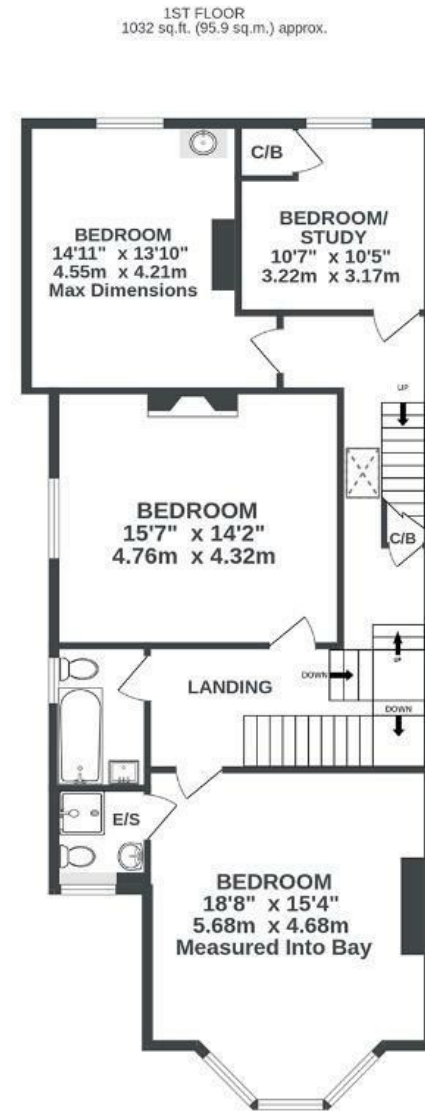
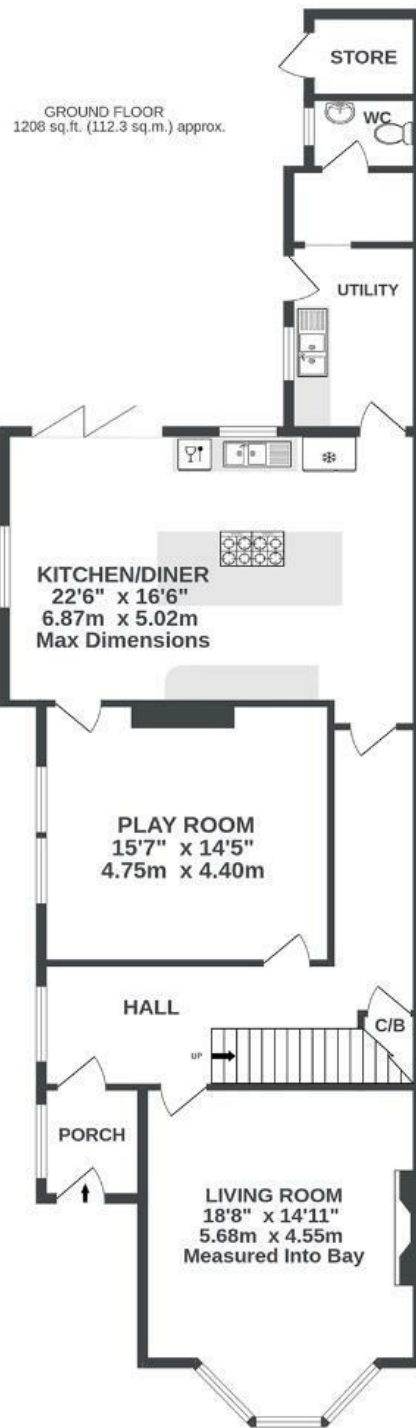

Illustrations are for reference purposes only, measurements are approximate, not to scale.

Boardwalk

Beaconsfield

KNOWLE, BRISTOL



£985,000



5 Bedrooms



BS4 2JF



2 Bathrooms

"The first time we set foot here, we knew what a special home it would be to grow our family in. It's massive; ample room for friends, working from home, even hosting a Christmas party for the street! Its heart is the open plan kitchen that flows out to the garden veranda. Dinner under there is a frequent treat. We've invested heavily in being "fit for the future"; solar PV, insulation, EV charger, and a high performance Ground Source Heat Pump. The warmest and most efficient house we've lived in."

